

MANUAL DE MONTAJE

F2H

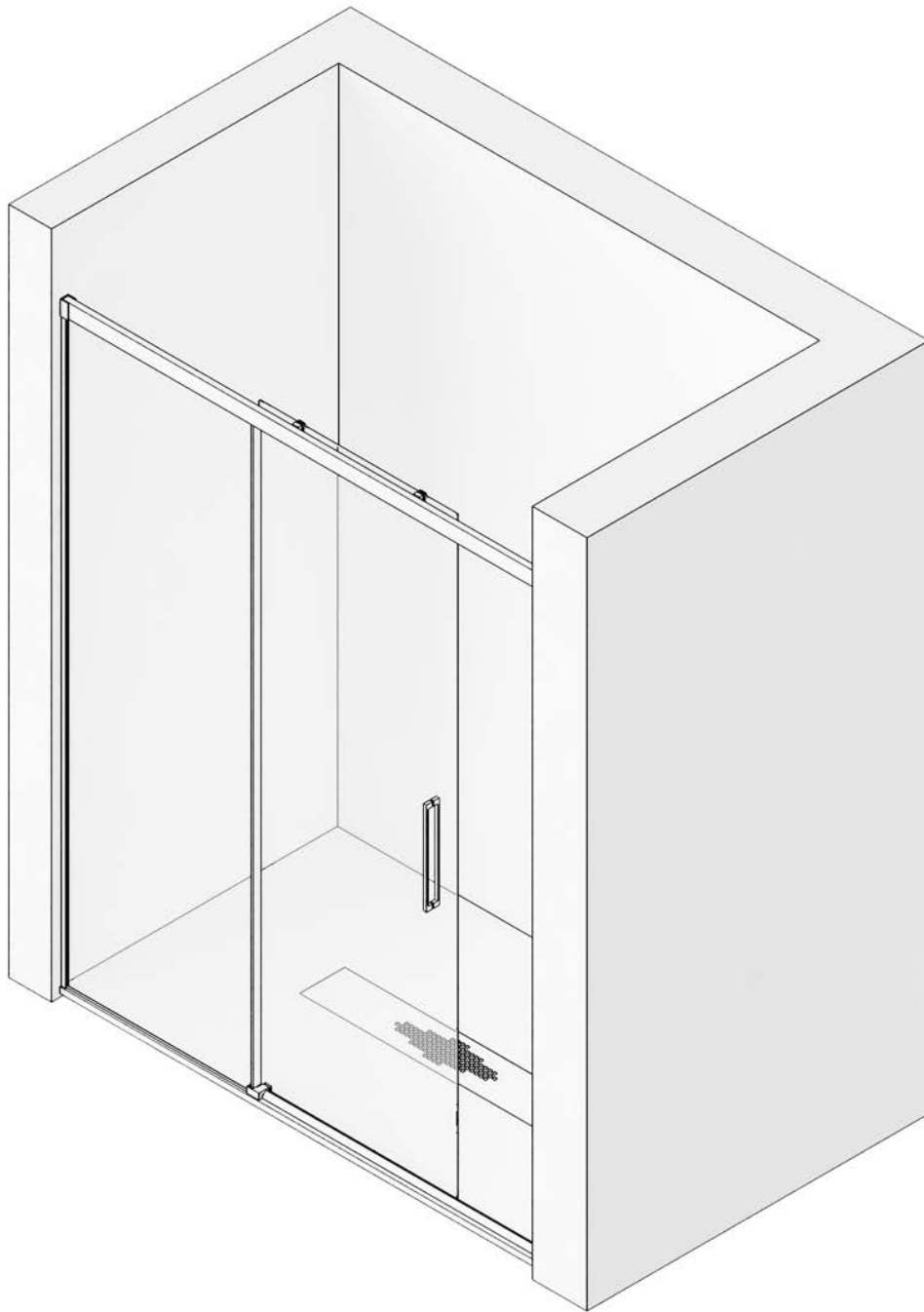

MAMPARA FRONTAL DE DUCHA

1 HOJA CORREDERA + 1 FIJA

F2H

1

PRESENTAMOS PERFIL "U" DE FIJO, EN PARED, SEGÚN CORRESPONDA SU POSICIÓN, NIVELÁNDOLO, A 3 MM. DEL BORDE DEL PLATO DE DUCHA Y MARCAMOS TALADROS.

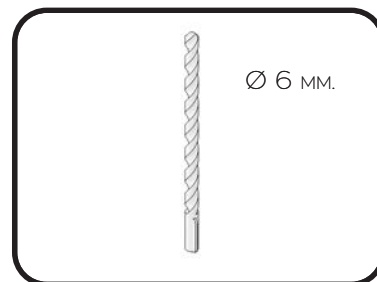
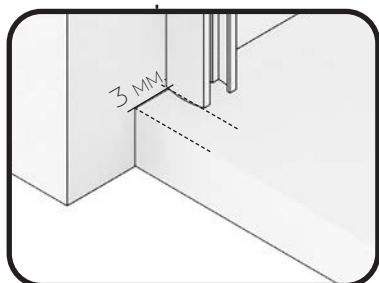

2

TALADRAR LAS PAREDES CON BROCA DE 6MM.

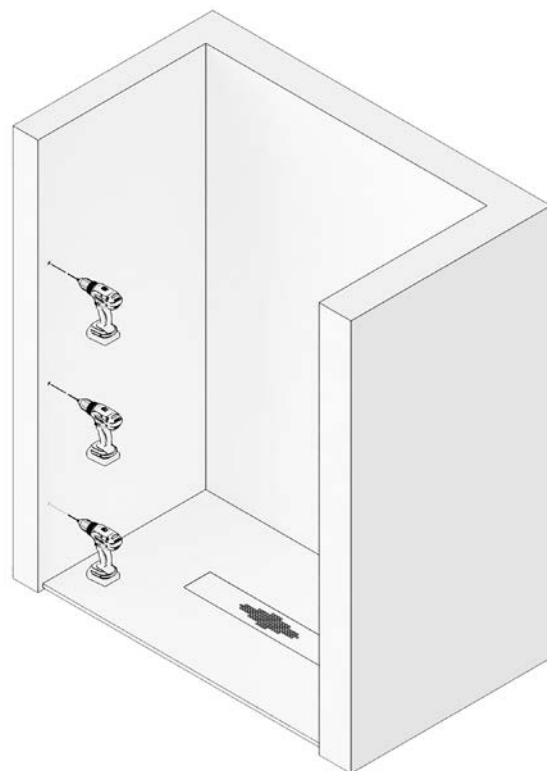

3

ATORNILLAR EL PERFIL "U" A PARED, FIJÁNDOLO CON TACOS DEL N° 6 Y LOS 3 TORNILLOS 4.2X32.

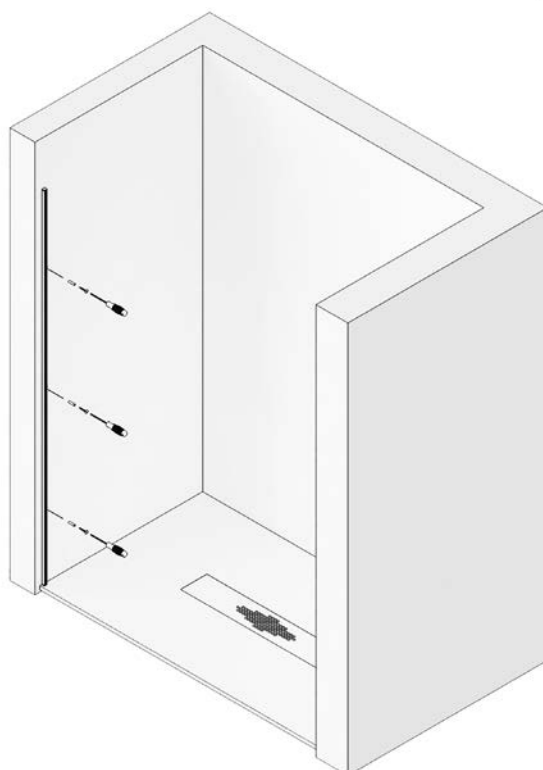

4

COLOCAMOS GOMA DE ESTANQUEIDAD INFERIOR EN LA HOJA FIJA E INTRODUCIMOS EL VIDRIO EN LA "U", APOYÁNDOLO SOBRE ESTA.

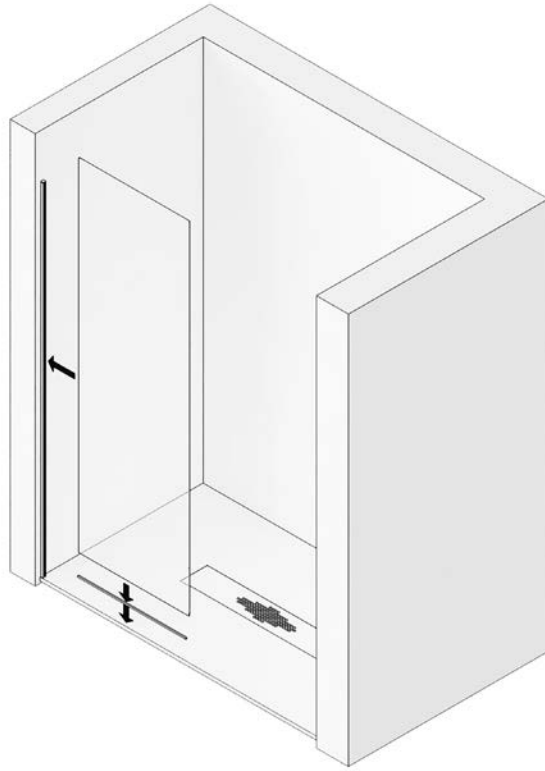

5

COLOCAR LA PINZA GUIA INFERIOR EN EL EXTREMO DEL VIDRIO FIJO, MONTÁNDOLA PREVIAMENTE SEGÚN CORRESPONDA SU POSICIÓN.

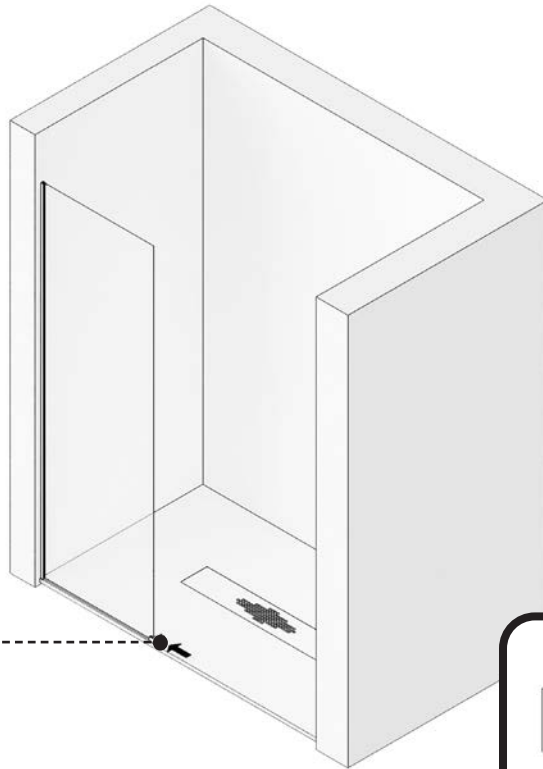

MONTAJE PINZA GUIA INFERIOR

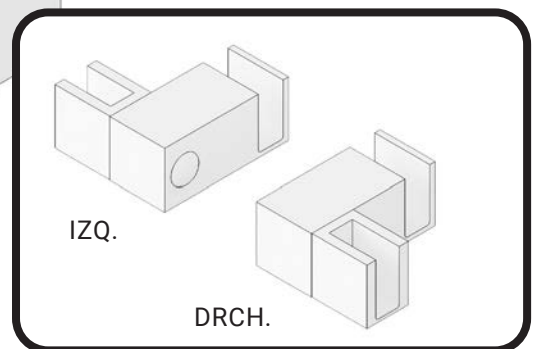
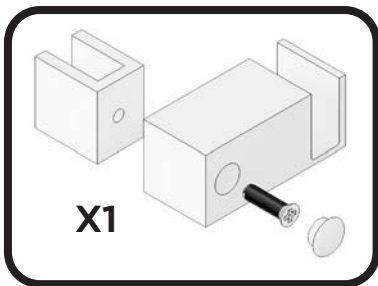

F2H

6

PRESENTAR GUÍA SUPERIOR CON VASOS, DE PARED A PARED, SOBRE EL VIDRIO FIJO, NIVELAR Y MARCAR LOS TALADROS.

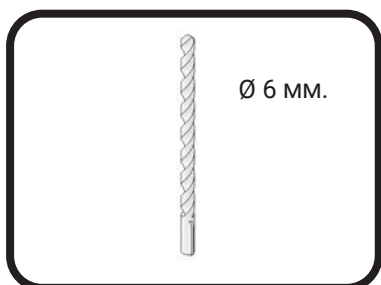
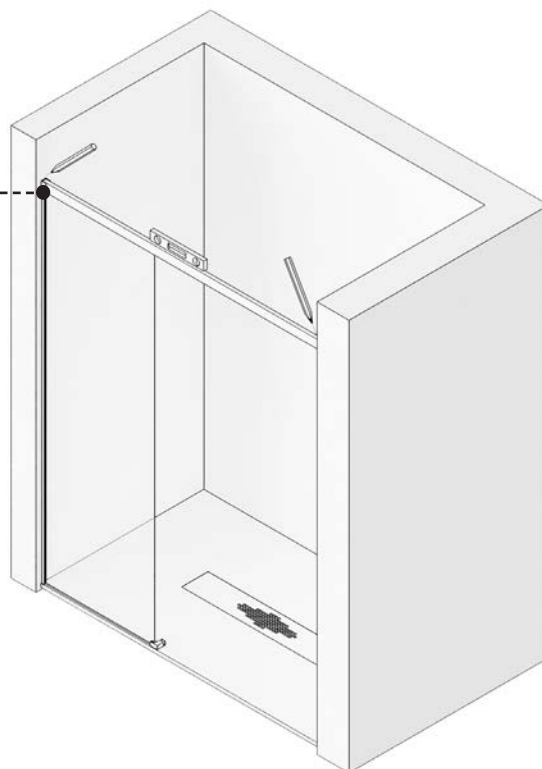
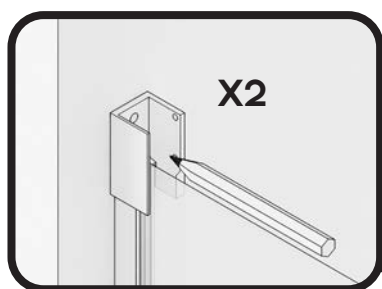

7

TALADRAR LA PARED CON BROCA DE 6MM.



RETIRAR CRISTAL FIJO SI FUESE NECESARIO.

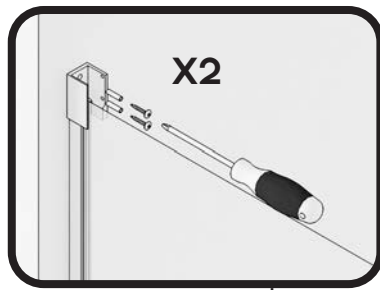

8

ATORNILLAR LOS VASOS SOPORTE GUÍA SUPERIOR A PARED.

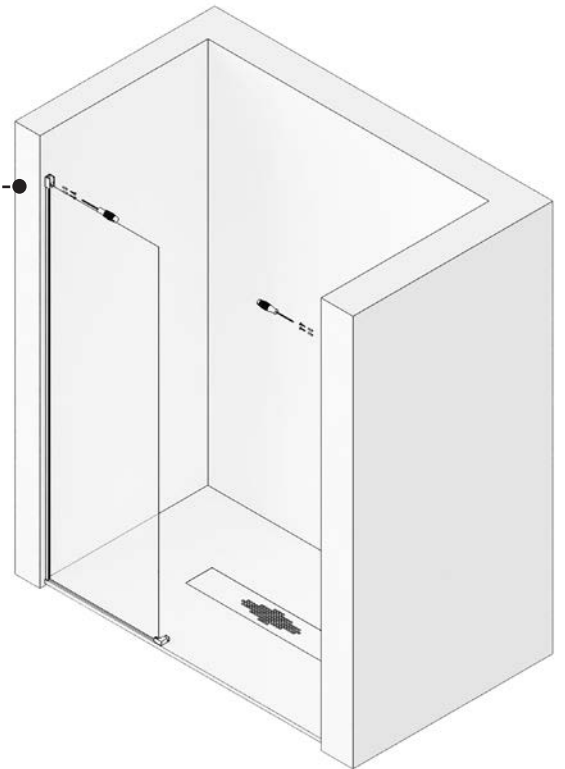

9

INTRODUCIR LOS 2 TOPES FRENO EN GUIA SUPERIOR, DESPLAZANDO UNO HACIA EL FINAL DE LA HOJA FIJA Y OTRO AL FINAL DE LA HOJA CORREDERA, COLOCAR LA GUIA SUPERIOR EN LOS VASOS COGIDA A PARED Y FIJAR LA COGIDA A LA GUIA MEDIANTE LOS TORNILLOS PRISIONEROS CON LLAVE HALLEN. ENGOMAR CRISTAL FIJO A PERFIL PARED Y A GUÍA SUPERIOR.

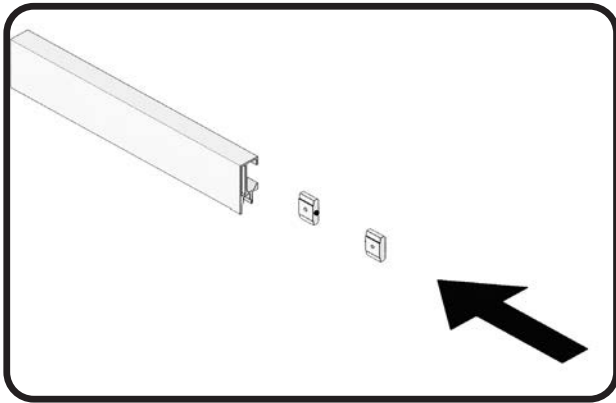

10

MONTAR CONJUNTO RUEDAS, GRADUADAS EN SU ALTURA MÁXIMA Y GOMA INFERIOR VIERTEGUAS EN HOJA CORREDERA.

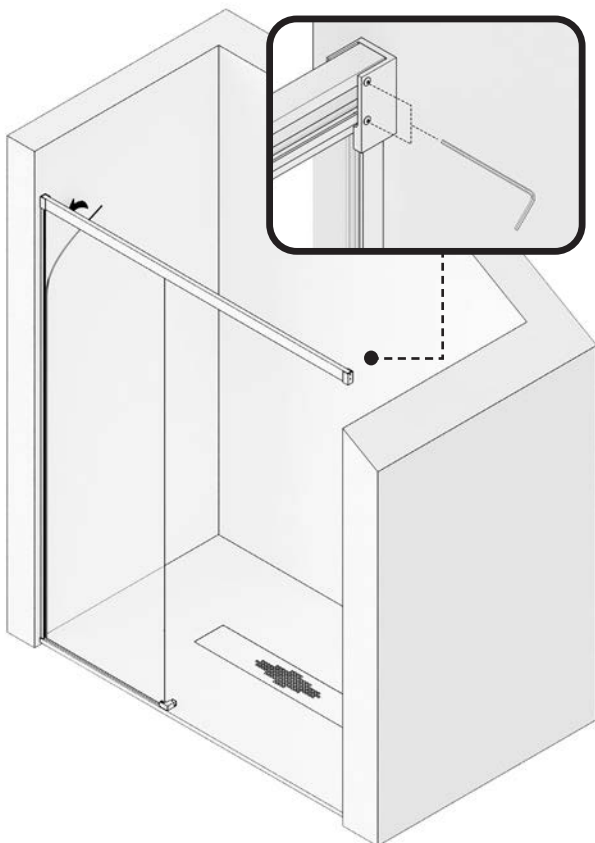

ALTURA MÁXIMA

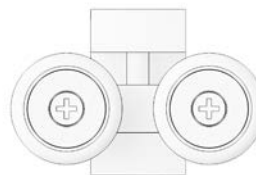

ALTURA MÍNIMA

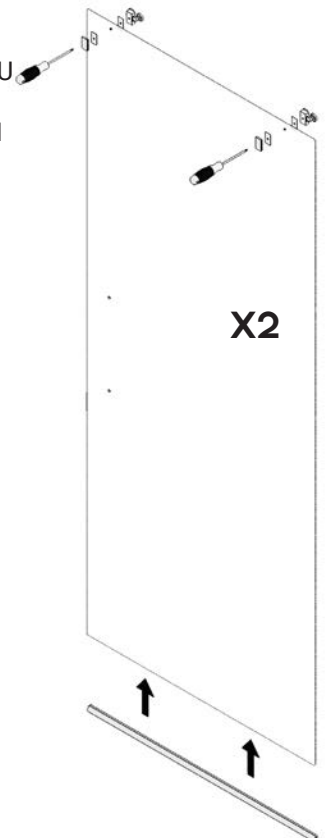
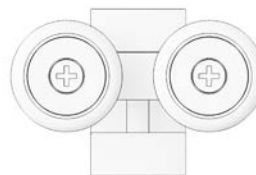

11

COLGAR LA HOJA CORREDERA EN LA GUIA SUPERIOR, INTRODUCIENDO EL CONJUNTO RUEDAS EN LA MISMA Y EN LA PINZA GUIA INFERIOR, GRADUANDO EN ALTURA Y NIVELANDO LA HOJA CORREDERA, HACIENDO DESCENDER LA HOJA MEDIANTE LOS TORNILLOS DE REGULACION DE RUEDAS, CON UN DESTORNILLADOR.

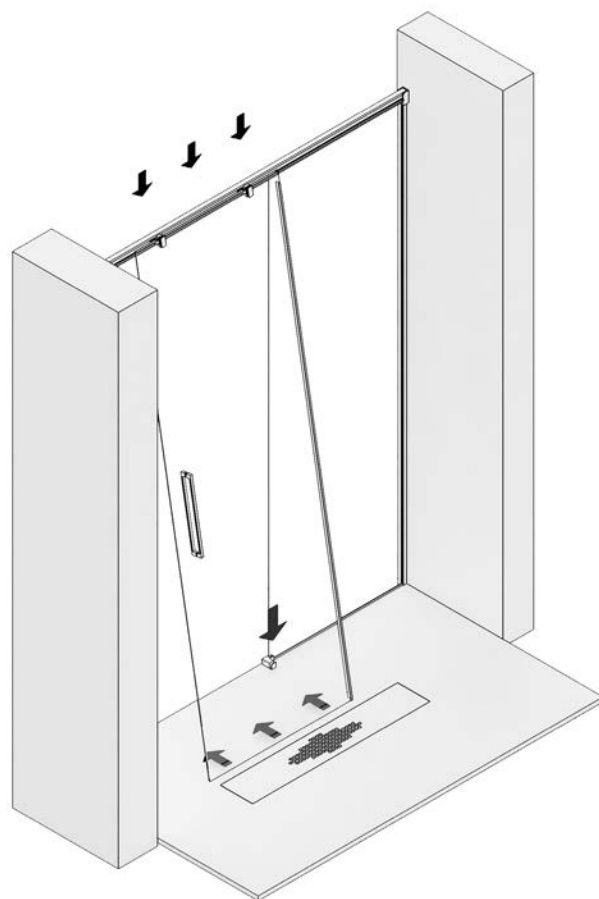
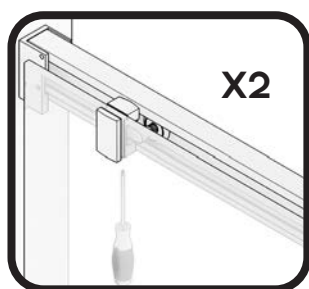

12

COLOCAMOS LAS GOMAS ALA DE CRUCE, UNA EN EL FIJO Y OTRA EN LA HOJA CORREDERA. COLOCAR EL ASA TIRADOR.

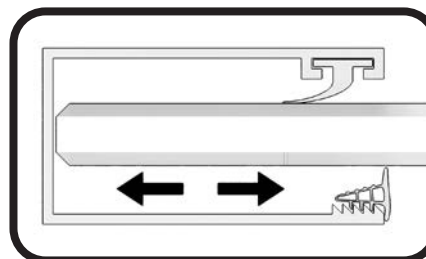
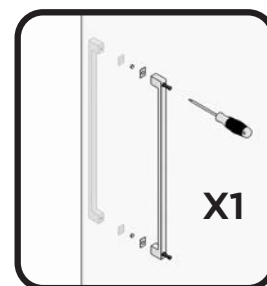
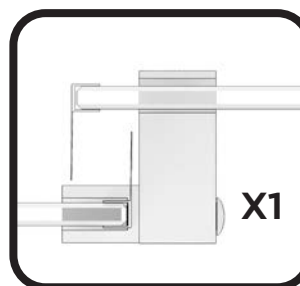

AJUSTAR EL JUEGO DE LOS VIDRIOS FIJOS SEGÚN NECESIDAD. FIJAR EL VIDRIO, ENGOMANDO EL CRISTAL CON EL PERFIL A PARED Y CON LA GUIA SUPERIOR.

13

FIJAR LOS TOPES FRENO EN SU POSICIÓN, MEDIANTE SU TORNILLO PRISIONERO.

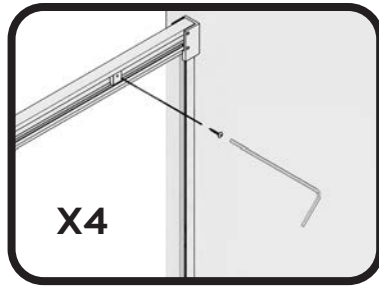

14

MEDIMOS, CORTAMOS, MONTAMOS SUS TAPONES Y PEGAMOS EL PERFIL DE ESTANQUEIDAD, DE PINZA INFERIOR A PARED POR DELANTE DE LA HOJA CORREDERA.

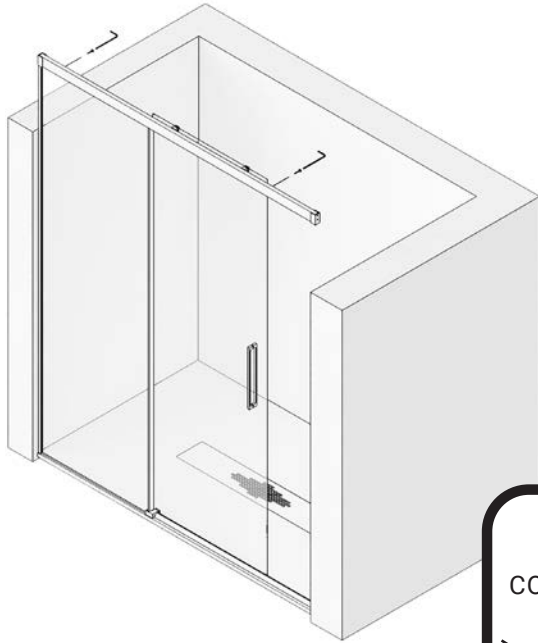
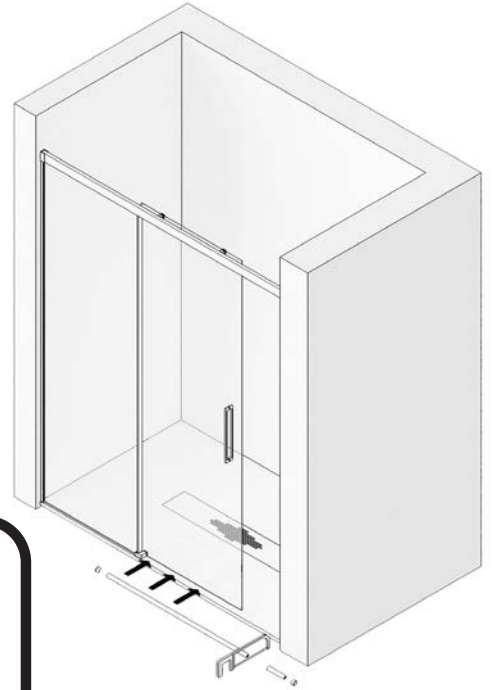

PERFIL DE ESTANQUEIDAD

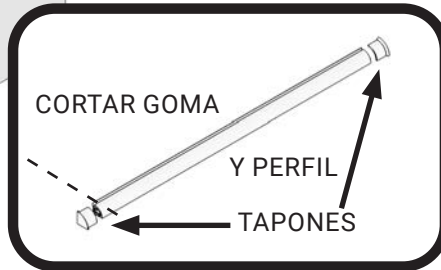





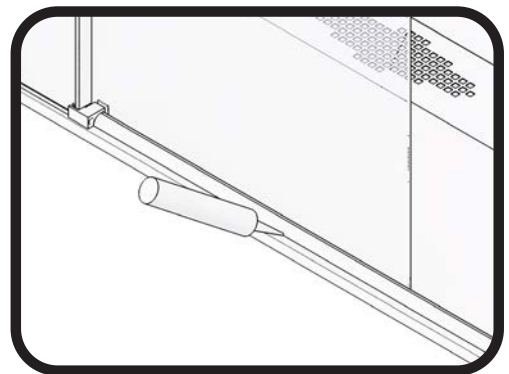
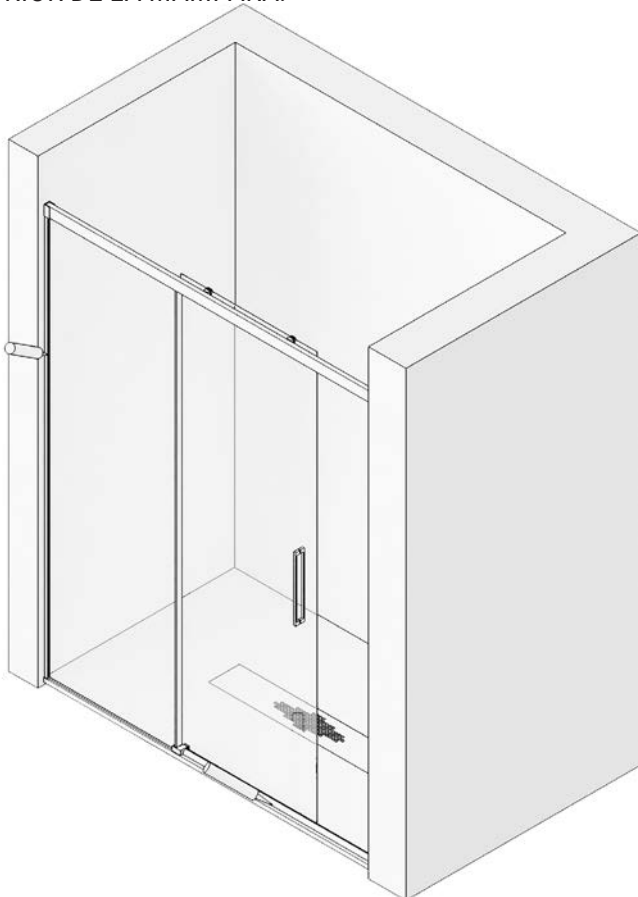



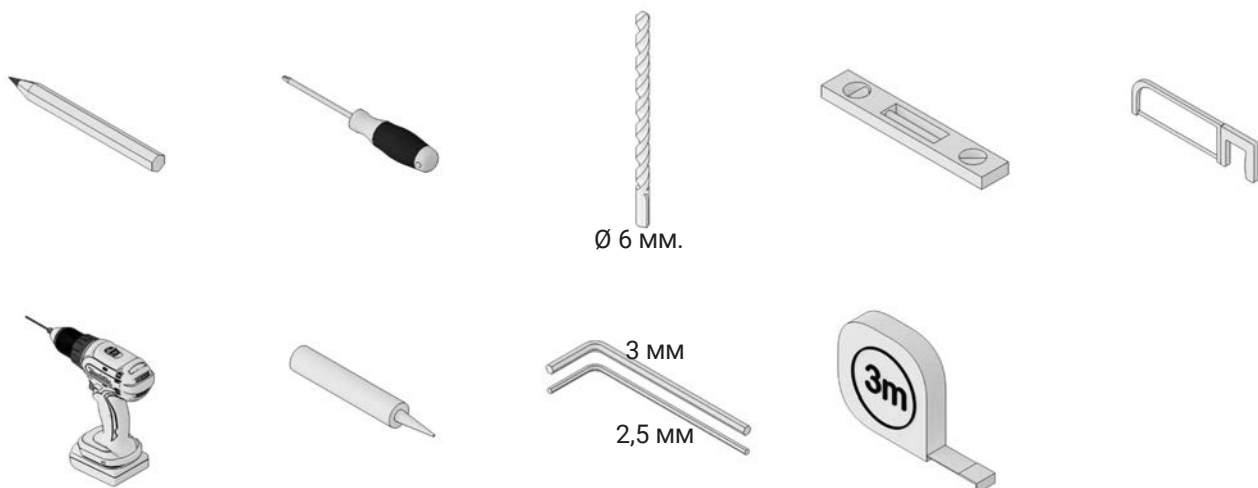



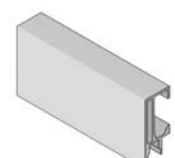

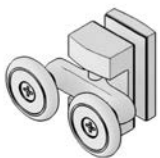

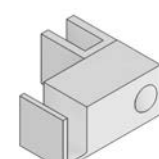
15

SELLAR CON SILICONA EL CONTORNO EXTERIOR DE LA MAMPARA.

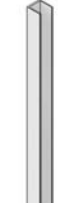

F2H



- | | | | | |
|--|---|---|---|--|
| <p>1X</p>  <p>HOJA FIJA</p> | <p>1X</p>  <p>HOJA CORREDERA</p> | <p>1X</p>  <p>PERFIL GUÍA SUPERIOR</p> | <p>2X</p>  <p>VASO O SOPORTE GUÍA</p> | <p>2X</p>  <p>TAPA EMBELLECEDORA VASO SOPORTE GUÍA</p> |
| <p>2X</p>  <p>RODAMIENTO SUP DOBLE TÁMBEN</p> | <p>2X</p>  <p>TOPE FRENO</p> | <p>1X</p>  <p>GUÍA PINZA INFERIOR</p> | <p>1X</p>  <p>ASA TIRADOR</p> | <p>1X</p>  <p>PERFIL "U" FIJO A PARED</p> |
| <p>1X</p>  <p>PERFIL DE ESTANQUEIDAD</p> | <p>2X</p>  <p>TERMINAL PERFIL DE ESTANQUEIDAD</p> | <p>1X</p>  <p>GOMA INFERIOR VIERTEGUAS PUERTA</p> | <p>1X</p>  <p>GOMA ESTANQUEIDAD INFERIOR FIJO</p> | <p>2X</p>  <p>GOMA ALA CRUCE</p> |
| <p>2X</p>  <p>GOMA CUÑA FIJACION VIDRIO GUIA</p> | <p>7X</p>  <p>TACOS Nº 6</p> | <p>7X</p>  <p>TORNILLO 4,2 X 32</p> | | |